

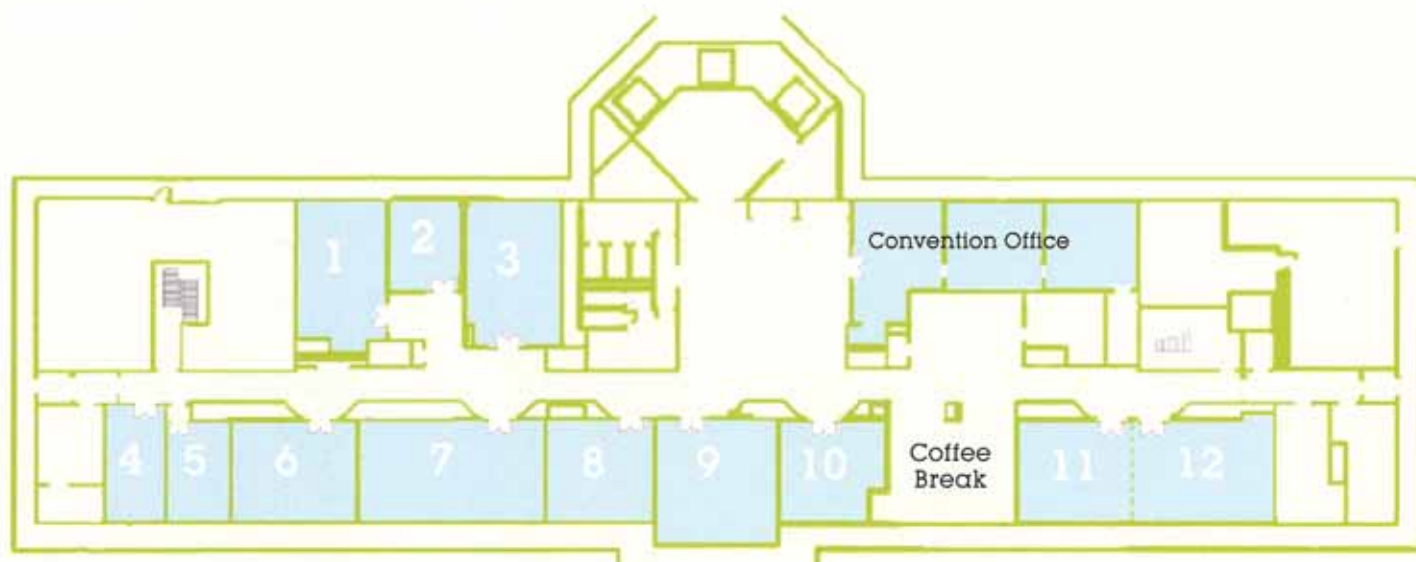

Sheraton

# CAPACITY CHART



### Key

- ROOM 1 ANDROMEDA
- ROOM 2 COSSIOPEIA
- ROOM 3 TAURUS
- ROOM 4 OFFICE 1
- ROOM 5 OFFICE 2
- ROOM 6 GALILEO

### Key

- ROOM 7 GEMINI
- ROOM 8 SIRIUS
- ROOM 9 FRIMOUT
- ROOM 10 CAPRICORN
- ROOM 11 SAGITARIUS
- ROOM 12 AQUARIUS

## ROOM DIMENSIONS AND SEATING CAPACITY

Room Name	Square Meters	Dimensions	Height	Banquet	Theater	Reception	Classroom	U-Shape	Square	Oval
ANDROMEDA	25.2	3.7' x 6.8'	2.6'	-	-	-	-	-	10	-
COSSIOPEIA	16	4' x 4.1'	2.6'	-	-	-	-	-	-	6
TAURUS	30.2	4.5' x 6.7'	2.6'	-	-	-	-	-	12	-
OFFICE 1	14.3	2.8' x 5.1'	2.6'	-	-	-	-	-	-	4
OFFICE 2	14.3	2.8' x 5.1'	2.6'	-	-	-	-	-	-	4
GALILEO	24	4' x 6'	2.6'	-	-	-	-	-	12	-
GEMINI	45	5' x 9'	2.6'	-	-	-	-	-	16	-
SIRIUS	26	4.9' x 5.3'	2.6'	-	-	-	-	-	-	6
FRIMOUT	23	3.9' x 5.9'	2.6'	-	-	-	-	-	8	-
CAPRICORN	22.3	4.2' x 5.3'	2.6'	-	-	-	-	-	-	6
SAGITARIUS	29.4	4.9' x 6'	2.6'	-	-	-	-	-	8	-
AQUARIUS	32.2	4.8' x 6.7'	2.6'	-	-	-	-	-	12	-

Sheraton Brussels Airport Hotel

ZAVENTEM, BELGIUM

Brussels National Airport

T +32 2 710 80 00

sheraton.com/brusselsairport

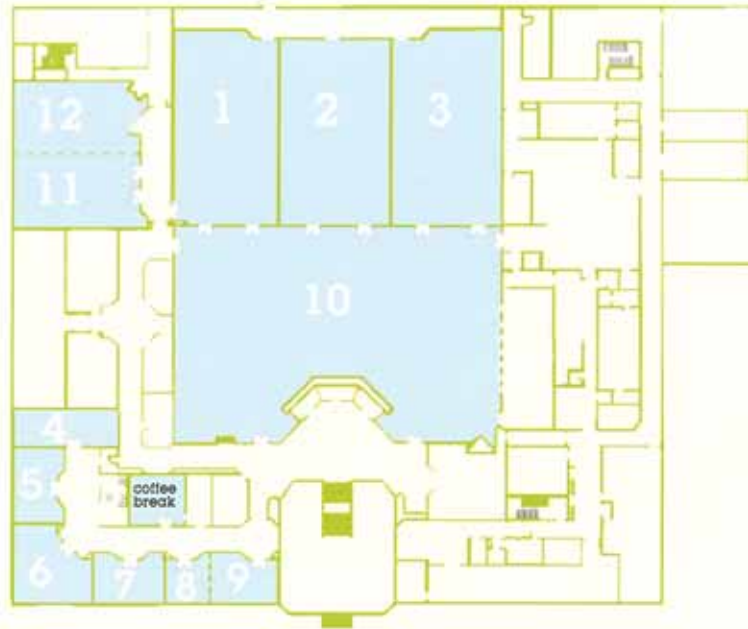

Key

- ROOM 1 GALAXY 1
- ROOM 2 GALAXY 2
- ROOM 3 GALAXY 3
- ROOM 4 CARAVELLE
- ROOM 5 SATELLITE 5
- ROOM 6 SATELLITE 4

Key

- ROOM 7 SATELLITE 3
- ROOM 8 SATELLITE 2
- ROOM 9 SATELLITE 1
- ROOM 10 ATRIUM
- ROOM 11 SATELLITE 6
- ROOM 12 SATELLITE 7

ROOM DIMENSIONS AND SEATING CAPACITY

Room Name	Square Meters	Dimensions	Height	Banquet	Theater	Reception	Classroom	U-Shape	Square	Oval
GALAXY 1	241.5	21' x 11.5'	3.5'	150	250	200	120	60	50	50
GALAXY 2	220.5	21' x 10.5'	3.5'	150	250	200	120	60	50	50
GALAXY 3	252	21' x 12'	3.5'	150	250	200	120	60	50	50
GALAXY 1&2&3	714	34' x 21'	3.5'	450	750	700	400	120	100	100
CARAVELLE	31.5	3.8' x 8.3'	3.5'	-	-	-	-	-	-	14
SATELLITE 1	48	5.8' x 8.3'	3.5'	-	50	50	18	20	22	20
SATELLITE 2	23	4' x 5.9'	3.5'	-	25	20	10	10	10	10
SATELLITE 3	52	6.7' x 7.8'	3.5'	-	50	60	18	20	22	20
SATELLITE 4	78	8.7' x 9'	3.5'	-	70	80	35	25	24	25
SATELLITE 5	51	6.7' x 7.7'	3.5'	-	50	60	18	20	22	20
SATELLITE 6	108	7.8' x 13.8'	3.5'	80	100	130	54	40	40	40
SATELLITE 7	108	7.8' x 13.8'	3.5'	80	100	130	54	40	40	40
SATELLITE 1&2	51	12' x 6'	3.5'	-	70	75	27	25	24	25
SATELLITE 6&7	216	14' x 15.5'	3.5'	100	200	300	110	50	45	45
ATRIUM	782	23' x 34'	15'	500	-	750	-	-	-	-

+ 12 BREAKOUT ROOMS ON 6th FLOOR